

# Quick-Start Guide

## POWER ON SEQUENCE

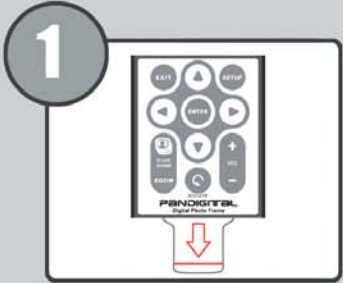

Remove the plastic insert before using the remote control.



Plug the AC adaptor into the photo frame and plug it into a wall outlet.

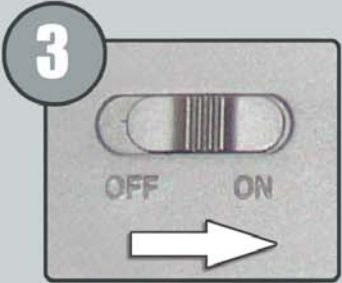

Turn the power switch on the back of the digital frame from "OFF" to "ON" position.



The frame will default to the images stored in internal memory when no memory card is present.

## VIEW IMAGES FROM CAMERA MEMORY CARD

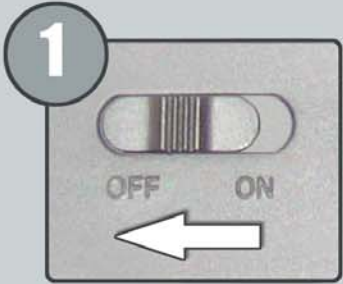

Make sure the unit is turned off.



Insert a camera memory card into one of the open slots.

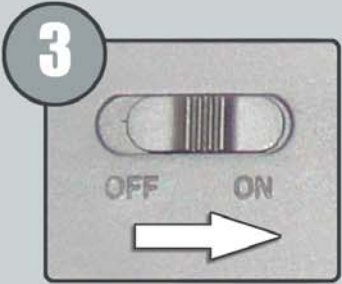

Turn on the power switch.



The frame will default to the images stored on the inserted memory card.

OR



Insert a camera memory card into one of the open slots.



Depress "EXIT" on the remote until you reach the "SELECT CARD" screen.



Highlight the card you inserted with the images on it and depress "ENTER" on the remote.



Select the type of media you would like to display (i.e. Photo, Music, Video).



Depress "SLIDE SHOW" button on the remote to begin.

## COPY IMAGES FROM CAMERA MEMORY CARD ONTO INTERNAL MEMORY



1 Insert a camera memory card into one of the open slots.



2 Depress "EXIT" on the remote until you reach the "SELECT CARD" screen.



3 Highlight the card you inserted with the images on it and depress "ENTER" on the remote.



4 Select the type of media you would like to display (i.e. Photo, Music, Video).



5 Depress the "SETUP" button on the file to bring up the on-screen display.



6 Using the "ARROW KEYS" on the remote, scroll down to "Copy File" and depress the "ENTER" button.



7 When prompted "Are you sure?", use the "ARROW KEYS" to highlight "YES" and depress the "ENTER" button.



8 Image has now been transferred to internal memory.

## COPY IMAGES FROM YOUR PC ONTO INTERNAL MEMORY

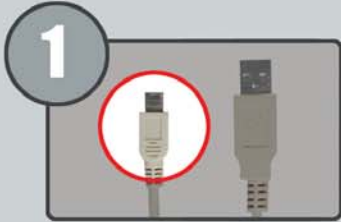

1 Connect the small end of the of the USB cable to the USB port on the side panel of the Digital Photo Frame.

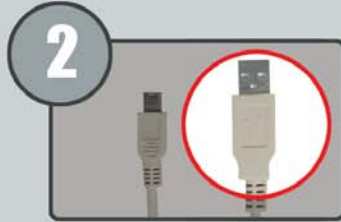

2 Connect the larger end of the USB cable to an available USB port on your computer.

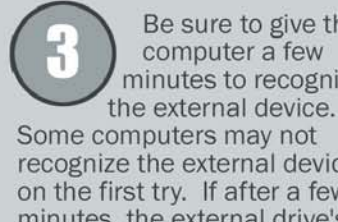

3 Be sure to give the computer a few minutes to recognize the external device. Some computers may not recognize the external device on the first try. If after a few minutes, the external drive's are not seen, unplug the USB cable, turn the frame off and then on and repeat the process.



4 5 drive letters entitled "Removable Disc" will appear under the "My Computer" icon in Windows, one for each of the memory card slots on the Digital Photo Frame and the last one is for the internal memory.

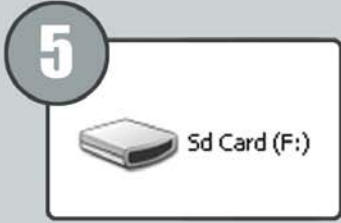

5 Double-click on the appropriate "Removable Disc" icon to access that card.



6 Open the folder on your computer that contains the images you wish to copy to the frame.



7 Highlight the image you want to copy to the frame and drag and drop the file to the appropriate "Removable Disc" folder.

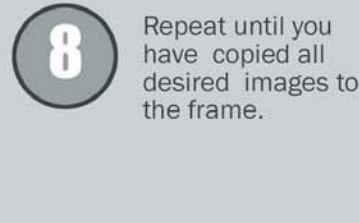

8 Repeat until you have copied all desired images to the frame.



9 The remote and frame function buttons will not operate when connected to a PC with the USB cable. Disconnect the USB cable before trying to operate the frame. It may be necessary to power off and then power on the frame to resume normal functions.

## CUSTOMER SERVICE

Updated manuals can be accessed via our web site

Web Site: <http://www.pandigital.net/>

Toll Free Number: 1-800-715-5354